

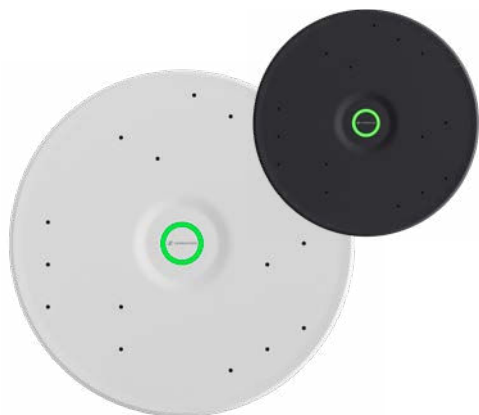

TeamConnect Ceiling Medium

Ceiling microphone array

(Firmware $\geq 1.2.7$)



Sennheiser
Control Cockpit

FEATURES

- Patented automatic dynamic beamforming
- TruVoicelift
- 15 SMD Electret condenser capsules made in Germany
- Perfect speech intelligibility
- Dante or Analog Output
- PoE
- Exclusion Zones
- Priority Zone
- Camera Control via talker position data
- IEEE 802.1x
- TLS 1.2
- 5 years warranty (with registration)

DELIVERY INCLUDES

TCC M-F-W (Art. no. 700170)

TCC M-F-B (Art. no. 700234)

Ceiling Mic Flush Mount Kit

- Microphone
- Front plate
- Flush Mount kit
- Chicago plenum connection box cover plate
- Phoenix connector
- Mounting rope
- Suspension kit

TCCM CT-W (Art. no. 700517)

TCCM CT-W 2FT (Art. no. 700518)

Ceiling Mic Flush Mount Kit (Ceiling Tile)

- Microphone
- Ceiling Tile mounting plate
- Phoenix connector
- Mounting rope
- Suspension kit

With a coverage of up to 50 m², our ceiling microphone TeamConnect Ceiling Medium is the right choice for mid-sized meeting rooms and lecture or collaboration spaces.

With this solution, Sennheiser provides an additional design option to seamlessly include our audibly superior ceiling microphone into your meeting room.

With all the great features of our trusted TeamConnect Ceiling 2 but in a more compact form, the TeamConnect Ceiling Medium microphone is a real problem-solver that allows cable-free tables and flexible furniture arrangement, while offering all of the TeamConnect Ceiling Solutions benefits like Trusted Sennheiser Audio Quality, efficient setup, brand agnostic integration, simple management and control, a sleek design and a sustainable impact.

TCC M-S-W (Art. no. 700294)

TCC M-S-B (Art. no. 700295)

Ceiling Mic Housing Kit

- Microphone
- Front plate
- Design housing
- Chicago plenum connection box cover
- Phoenix connector
- Mounting rope
- Suspension kit

CONTROL SOFTWARE

Sennheiser Control Cockpit

free download at:

www.sennheiser.com/control-cockpit-software





TeamConnect Ceiling Medium

Ceiling microphone array

(Firmware $\geq 1.2.7$)

SPECIFICATIONS

| Product properties | |
|-------------------------------|---|
| Dimensions (Ø x H) | 407 x 46 mm |
| | Ceiling Tile: |
| | 590,8 mm x 590,8 mm x 45,8 mm |
| Weight | Ceiling Tile US: |
| | 606,5 mm x 606,5 mm x 45,8 mm |
| | max. 4,9 kg (10.8 lbs) |
| Audio Output | Ceiling Tile: 4,5 kg (9.9 lbs) |
| | Ceiling Tile: US 4,6 kg (10.1 lbs) |
| | 1 x 3-pin terminal (fits Phoenix contact MCVW 1.5-3-ST-3.81) |
| Ethernet / Control | 1x Digital Dante™ Network Audio (RJ-45) |
| | 1 x RJ-45 Ethernet Port for PoE power supply and data/control communication |
| | PoE IEEE 802.3af Class 3 or PoE IEEE 802.3at / Type 2 / Class 4 (when cascaded) |
| Power consumption | approx. 8 W |
| Safety certification | Plenum tested IEC/EN 62368-1 (including UL 2043 testing and compliance) |
| Acoustic properties | |
| Transducer principle | Pre-polarized condenser microphone |
| AF frequency response | 100 Hz - 16.000 Hz |
| Sensitivity | 0 dBV/Pa (1020 mV/Pa) |
| Signal-to-noise ratio | 77 dB (A) |
| Equivalent noise level | 17 dB (A) |
| Number of microphone capsules | 15 |
| Pick-up pattern | Beam Pattern |
| Max. sound pressure level | 98 dB SPL |
| Dynamic range | 81 dB (A) |
| Ambient conditions | |
| Temperature | Operation: 0 - 40°C (32 - 104 °F) |
| | Storage: -10 - 60°C (14 - 140 °F) |
| Relative air humidity | 20 - 95 %, non-condensing |

ACCESSORIES

| Article | Description | Art. no. |
|------------------|---|----------|
| TCC M SK | Ceiling Mic M Suspension Kit 3x Ceiling installation threads 3x 16.4 ft/ 5m length steel cables 3x Ceiling housing threads | 700237 |
| TCC M SFP-W | Ceiling Mic Spare Front Plate white | 700235 |
| TCC M SFP-B | Ceiling Mic Spare Front Plate black | 700236 |
| TCC M H-W | Ceiling Mic Housing white | 700238 |
| TCC M H-B | Ceiling Mic Housing black | 700239 |
| TCCM CT-FP-W | TCCM square front plate 60 cm | 700515 |
| TCCM CT-FP-W 2FT | TCCM square front plate 2ft | 700156 |

CONNECTIONS AND OPERATING ELEMENTS

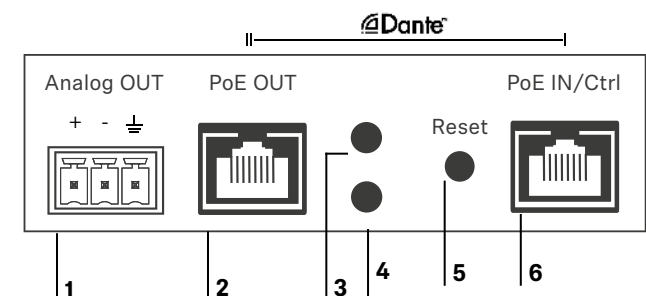

- | | | |
|---|--------------------|-------------------------------------|
| 1 | Analog Out | 3-pin terminal for analog audio out |
| 2 | PoE OUT | Daisy Chaining / Dante™ II |
| 3 | LED | Status |
| 4 | LED | PoE+ |
| 5 | Reset | Factory reset switch |
| 6 | PoE IN/CTRL | PoE / Control / Dante™ I |



TeamConnect Ceiling Medium

Ceiling microphone array

(Firmware $\geq 1.2.7$)

INSTALLATION VARIANTS



Surface Mounted

mounted directly below the ceiling

TCC M-S is used to surface mount or suspend the TeamConnect Ceiling Medium. It comes with a black or white TeamConnect Ceiling M and matching housing.



Suspended

suspended from the ceiling

The TCC M SK Ceiling Mic Suspension kit is for use when installing the TeamConnect Ceiling Medium in high-ceilinged rooms. It consists of three 16.4 ft (5m) steel cables that can be adjusted to fit the required installation height.



Flush Mounted

installed flush in a grid ceiling

The TCC M-F Flush Mount Kit is used to install the TeamConnect Ceiling Medium flush to the ceiling. It comes with a TeamConnect Ceiling M and flush mount accessories.



Ceiling Tile

Installed flush with mounting plate in a grid ceiling

The TCC M CT ceiling installation set is used for installation in suspended grid ceilings. It is supplied with a TeamConnect Ceiling Medium and a square front plate (in a 2-foot or 60 cm version).

PORT-INFORMATION

Application layer

| Port | Protocol | Service |
|------|----------|--------------------|
| 443 | HTTPS | Web UI |
| 443 | HTTPS | SSC update service |

| Product |
|----------------------------|
| Sennheiser Control Cockpit |
| Sennheiser Control Cockpit |

Transport layer

| Port | Protocol | Service |
|------|----------|-------------------------------|
| 22 | SCP/SSH | Certificate management |
| 443 | TCP | Firmware update |
| 443 | TCP | SSC Sound Control Protocol v2 |
| 5353 | UDP | mDNS (Multicast 224.0.0.251) |

| Product |
|----------------------------|
| TeamConnect Ceiling Medium |
| TeamConnect Ceiling Medium |
| TeamConnect Ceiling Medium |
| TeamConnect Ceiling Medium |



TeamConnect Ceiling Medium

Ceiling microphone array

(Firmware $\geq 1.2.7$)

FREQUENCY RESPONSE

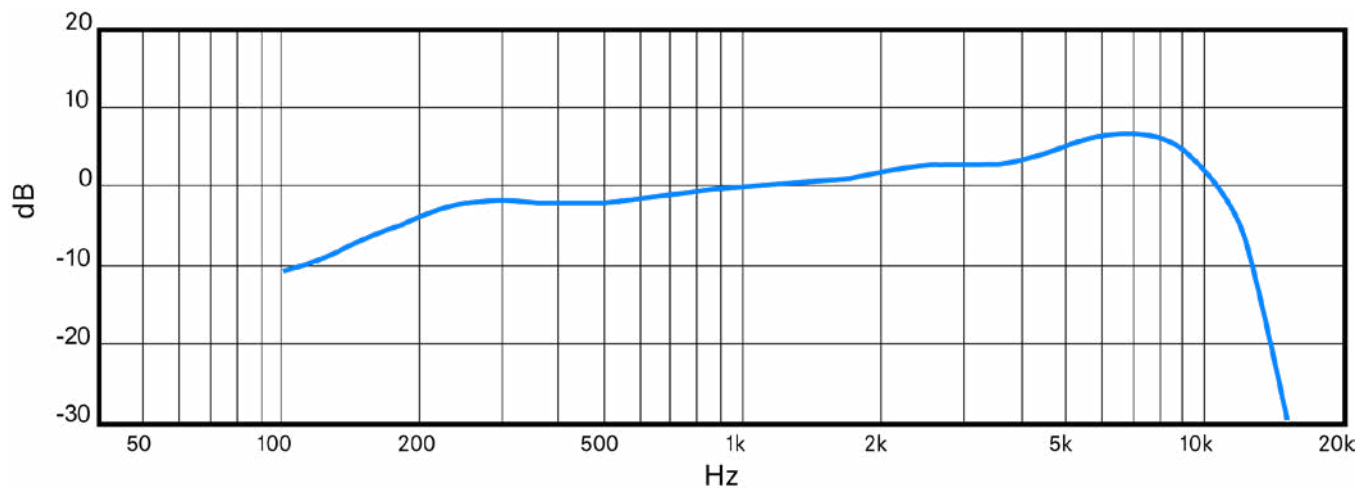

POLAR PATTERN

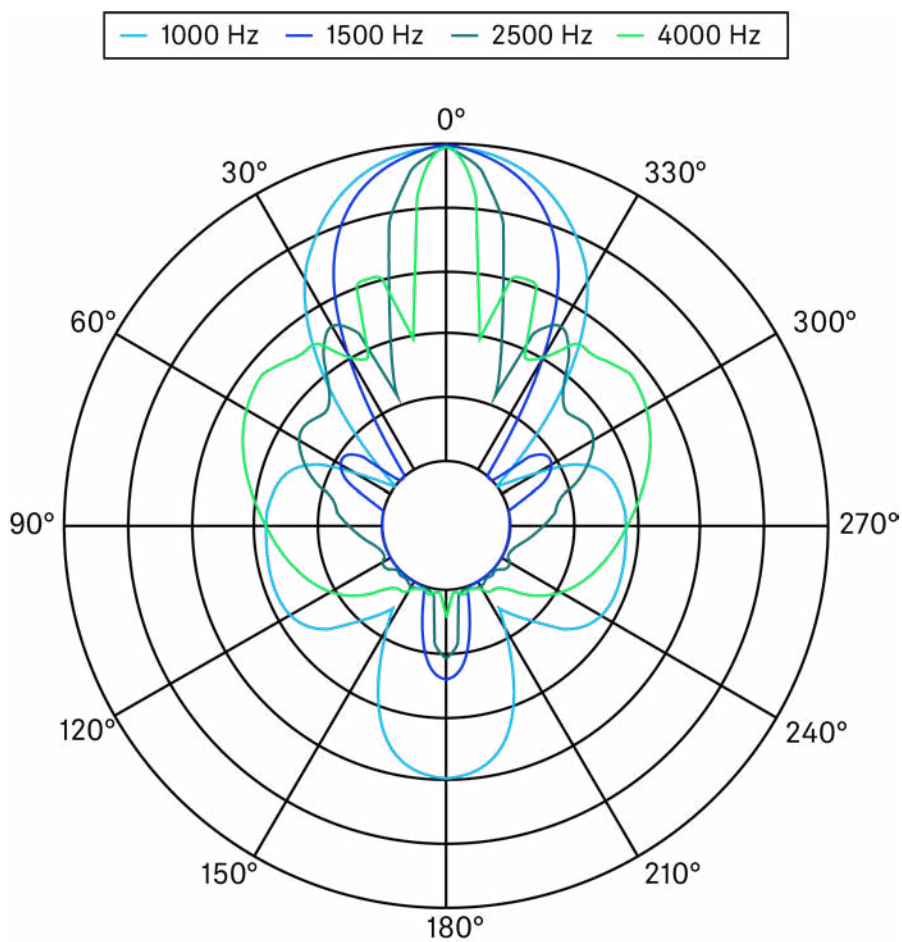



TeamConnect Ceiling Medium

Ceiling microphone array

(Firmware $\geq 1.2.7$)

DIMENSIONS

Flush Mounted

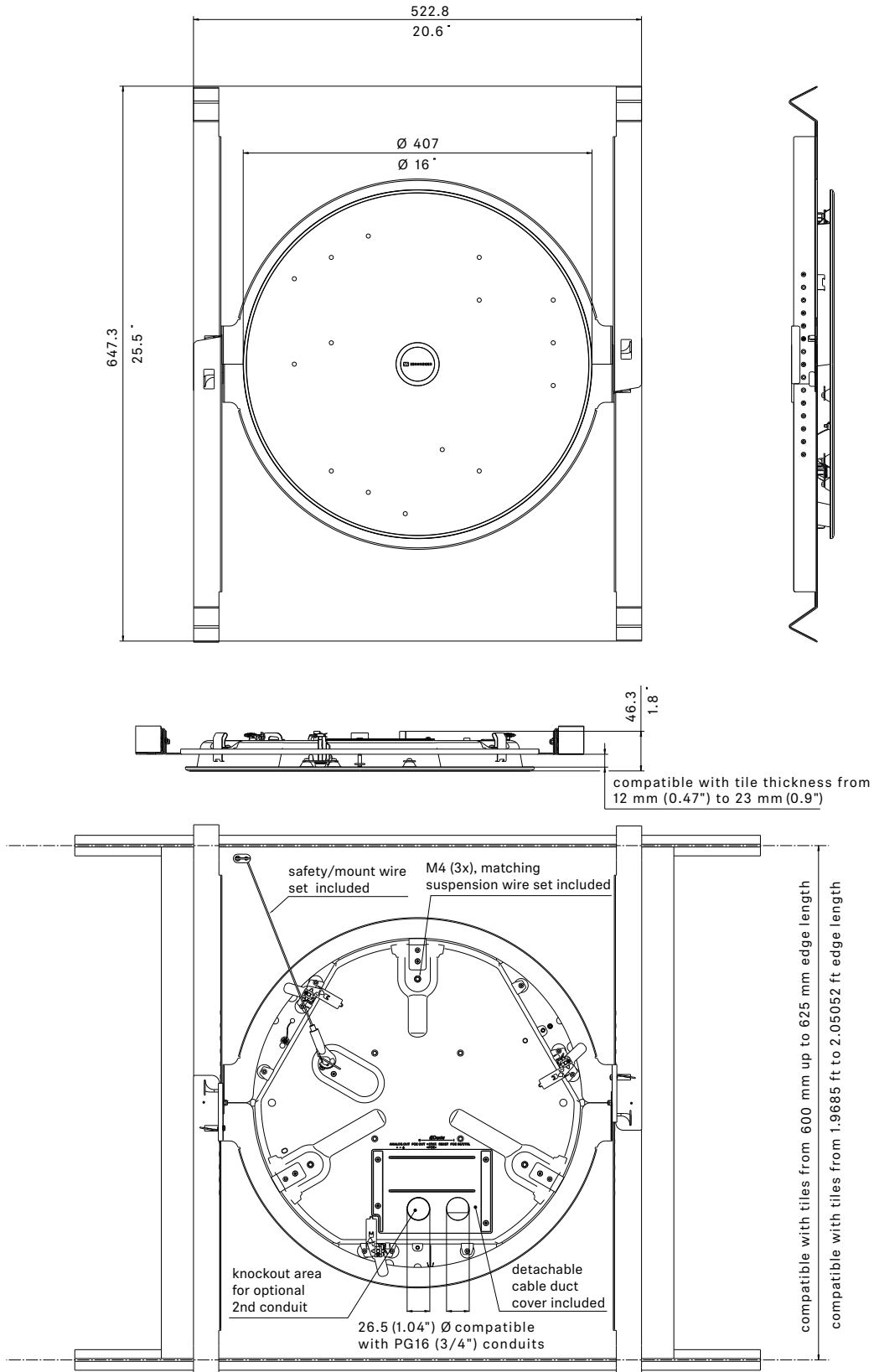



TeamConnect Ceiling Medium

Ceiling microphone array

(Firmware $\geq 1.2.7$)

DIMENSIONS

Flush Mounted

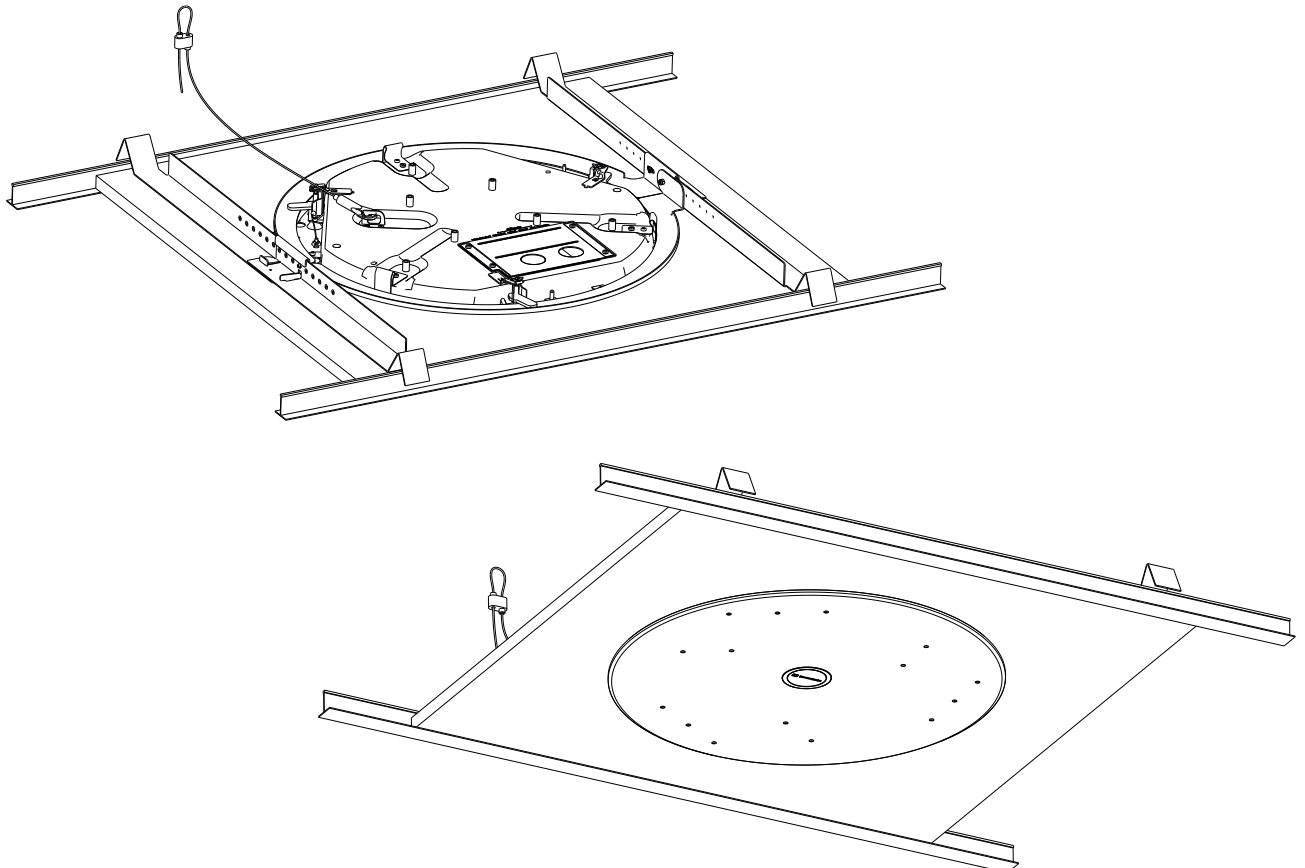
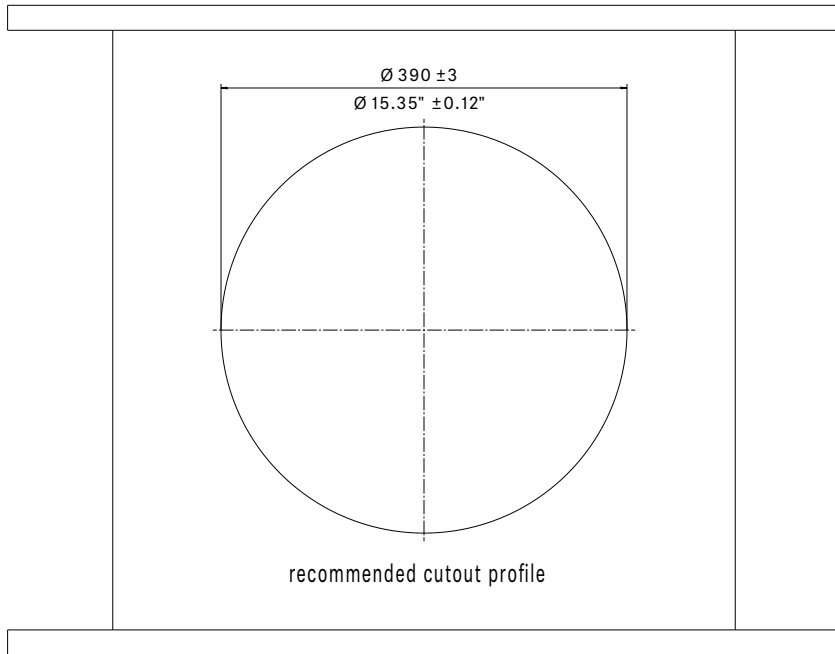



TeamConnect Ceiling Medium

Ceiling microphone array

(Firmware $\geq 1.2.7$)

DIMENSIONS

Ceiling Tile

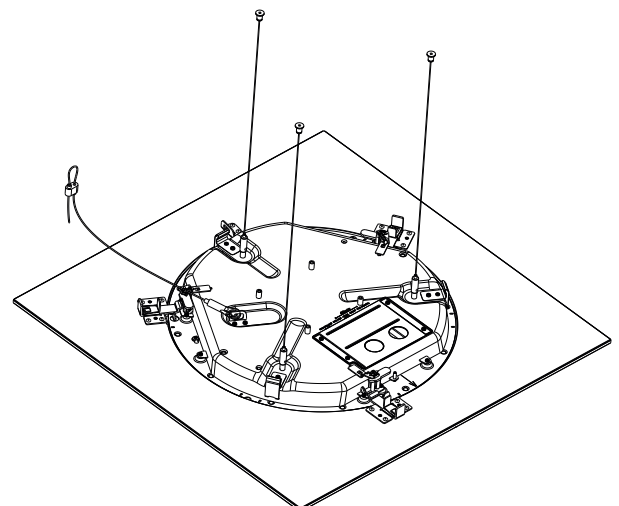
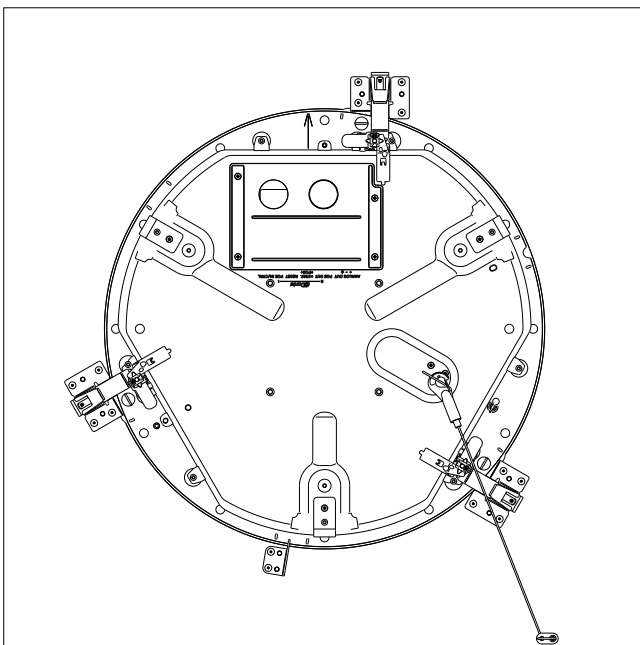
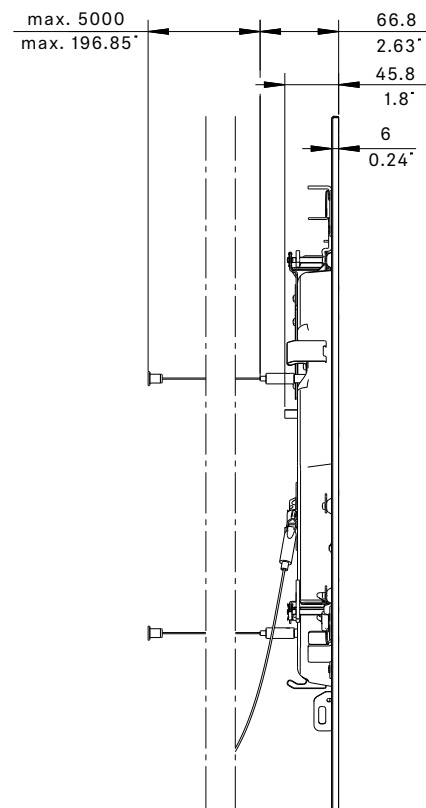
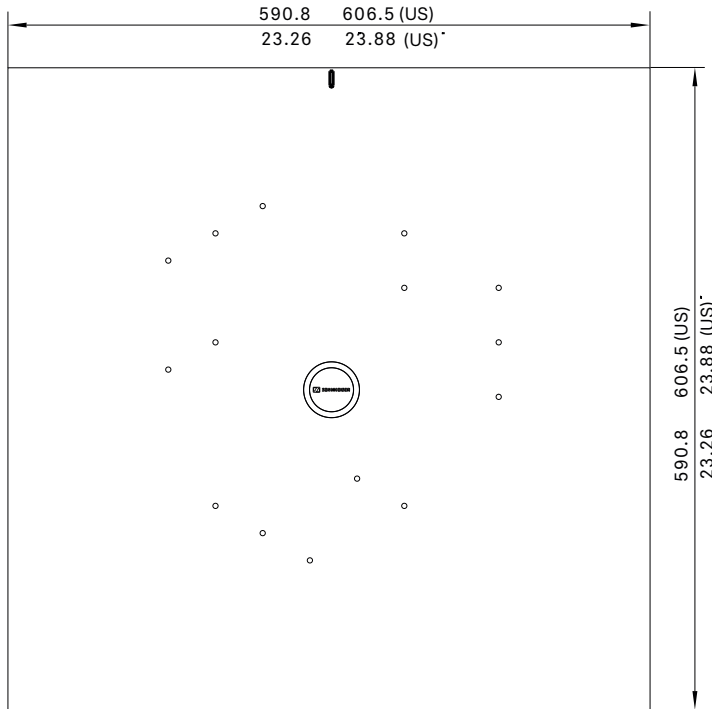



TeamConnect Ceiling Medium

Ceiling microphone array

(Firmware $\geq 1.2.7$)

DIMENSIONS

Surface Mounted

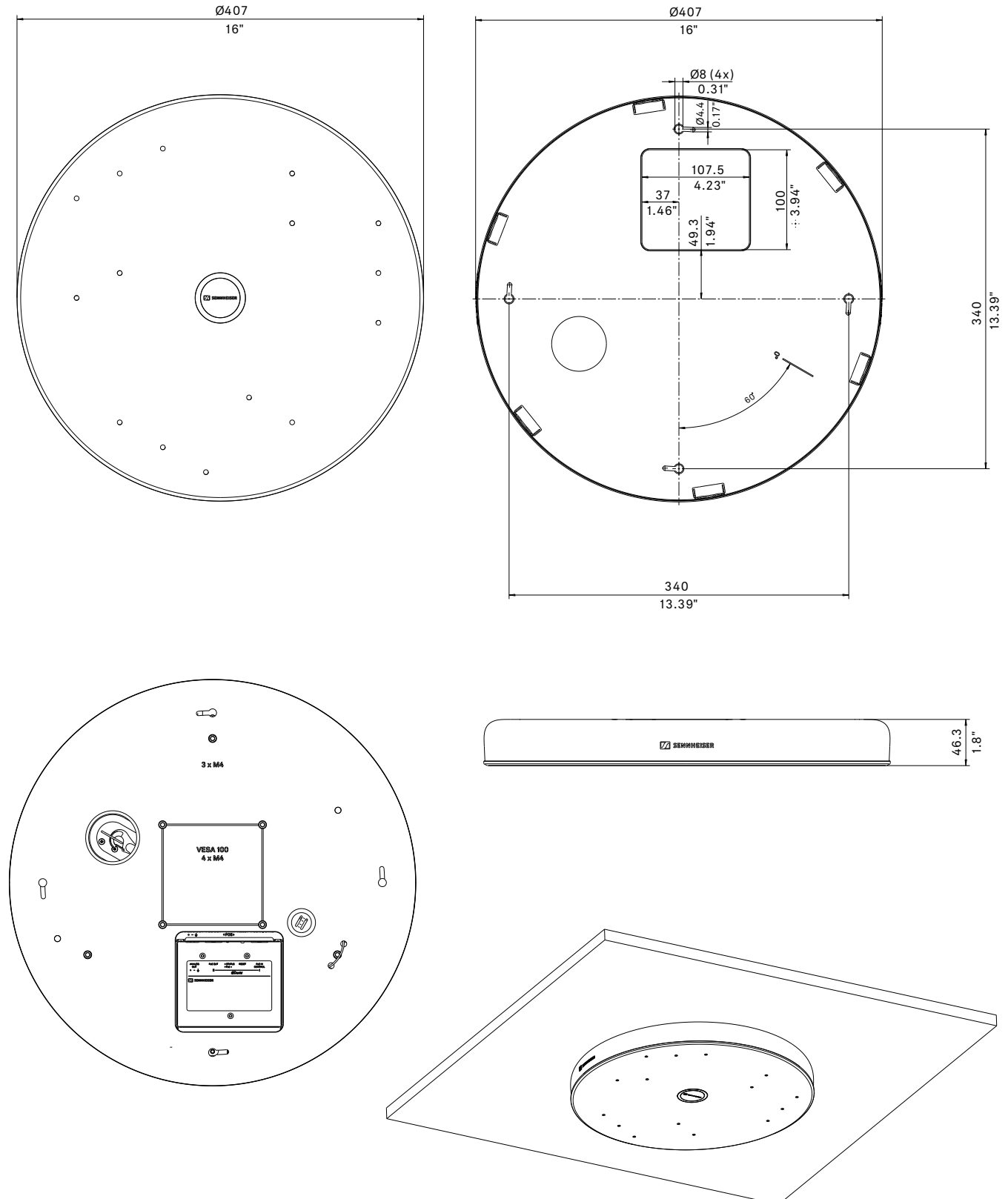



TeamConnect Ceiling Medium

Ceiling microphone array

(Firmware $\geq 1.2.7$)

DIMENSIONS

Suspended

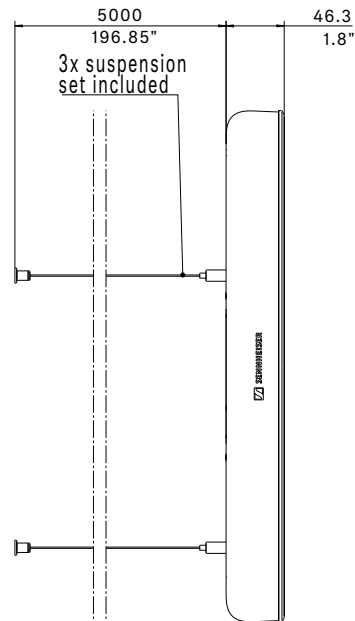
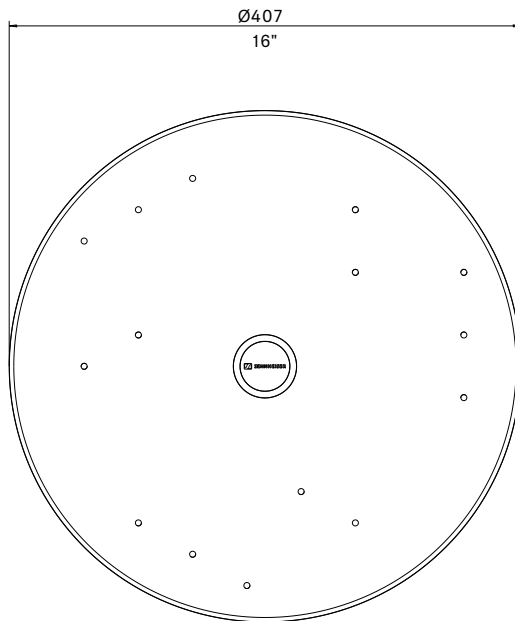

view from below, hole pattern, suspended mount

